



Future Development in Capel **Have Your Say**

Dover District Council are in the process of producing their second Local Plan.

The stages of this process are: -

- Consultation on draft Local Plan (Regulation 18): January 2020 – March 2020 (8 weeks)
- Review and finalise Local Plan: April 2021 - October 2021
- Consultation on proposed submission version of the Local Plan (Regulation 19): November 2021 – December 2021 (minimum 6 weeks)
- Submission of the Local Plan for Examination – February 2022
- Local Plan Examination – June 2022
- Adoption of Local Plan – February 2023

What is a Local Plan?

Basically, Dover District Council is required to plan future development in the district from 2020 to 2040

Therefore, the Local Plan sets out to identify plots of land throughout the district that are suitable for development.

Here in Capel, 16 plots of land were offered for development by local landowners during the evidence gathering stage.

Of the 16 plots, 11 will not be taken forward to the next stage of assessment as the sites have been assessed and considered unsuitable.

Of the remaining 5 plots, 4 are available for development and 1 has now got outline planning permission from the previous Local Plan and will not be taken forward.

Have Your Say.

The first public consultation runs from the 20th January 2020 for 8 weeks.

Dover District Council would like to hear your views.

Capel Parish Council would also like to hear your views so that the Parish Council's submission to Dover District Council can reflect the views of our Parishioners.

To do this, please look at the enclosed flyer and have your say.

For your information.

The first Local Plan took around 5 year to develop and was adopted in 2015.

Initially from around 16 plots in Capel, there were three plots of land that were finally approved for development

Currently, the first plot, George Close (Formally Grasslands) is complete with 40 dwellings.

The second plot on the junction of Capel Street and Winehouse Lane is under construction with 4 dwellings.

The third plot in Capel Street has outline planning consent for 34 dwellings.

Capel le Ferne

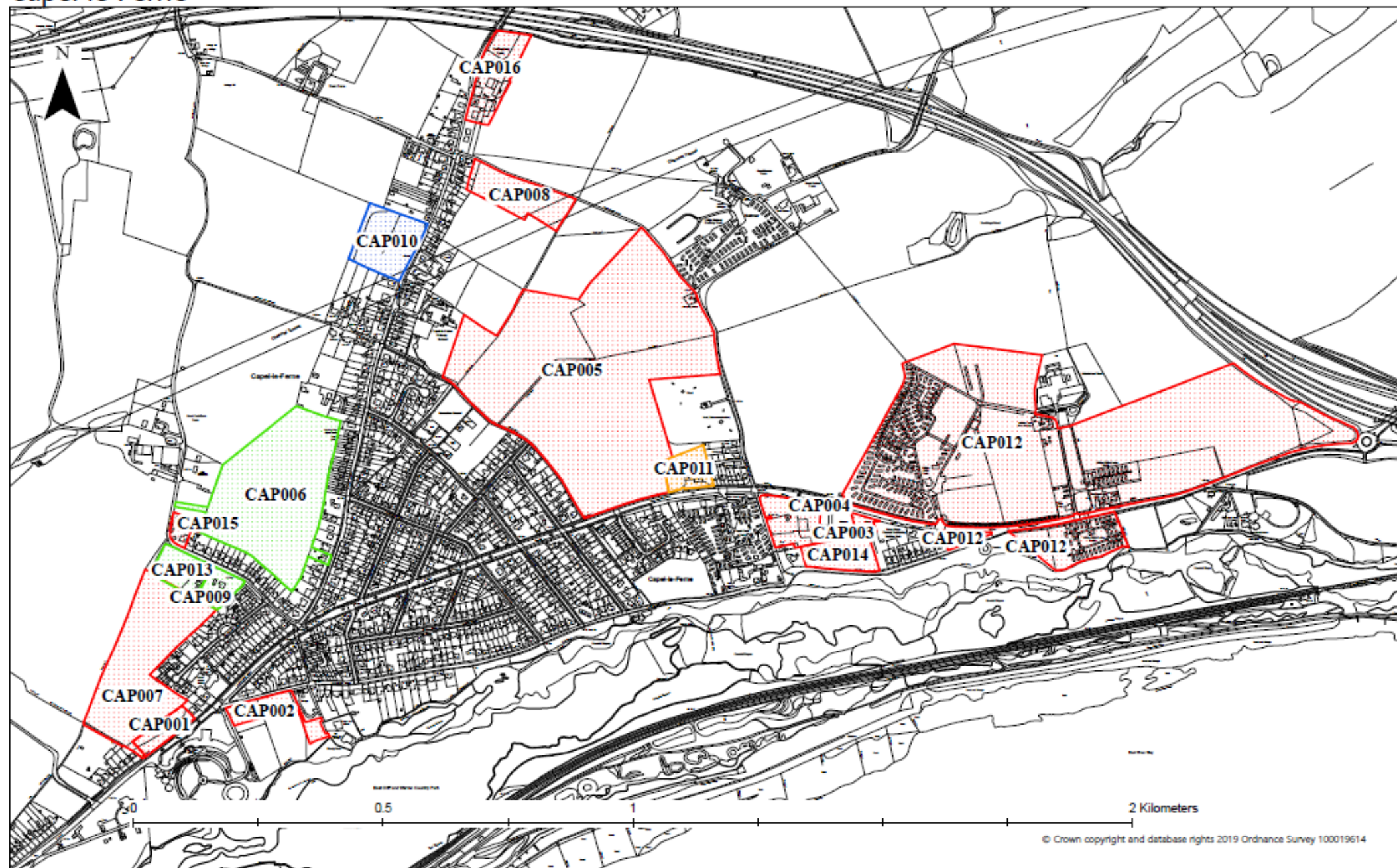

HELAA Suitability Assessment

- Green
- Red
- Amber
- Site_with_Planning_Consent

HELAA Availability Assessment

- No hatch Available
- No Contact/Unavailable
- Potentially Available